

Inline PTS Lever Tools (4 to 14 Nm)

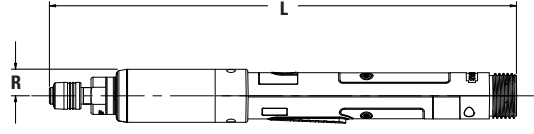

Model	Rated Speed		Torque		"R" Side to Center		"L" Length		Weight		Output
	RPM	Nm	lb ft	mm	in	mm	in	kg	lb	Standard	
EB02LP-4	1113	4	3	20.4	0.8	358.8	14.1	0.74	1.63	1/4" QC	
EB12LP-6	2301	5	3.7	20.4	0.8	358.8	14.1	0.69	1.52	1/4" QC	
EB02LP-6	782	6	4.4	20.4	0.8	358.8	14.1	0.74	1.63	1/4" QC	
EB12LP-9	1595	9	6.6	20.4	0.8	358.8	14.1	0.69	1.52	1/4" QC	
EB02LP-9	505	9	6.6	20.4	0.8	358.8	14.1	0.74	1.63	1/4" QC	
EB12LP-14	1022	14	10.3	20.4	0.8	358.8	14.1	0.69	1.52	1/4" QC	

Inline Tools (4 to 39 Nm)

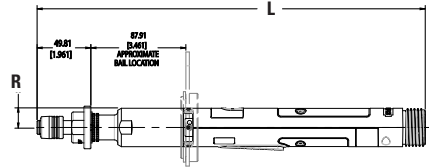

Model	Rated Speed		Torque		"R" Side to Center		"L" Length		Weight		Output
	RPM	Nm	lb ft	mm	in	mm	in	kg	lb	Standard	
EB02LB-4	1113	4	3	17.8	0.7	358.8	14.1	0.74	1.63	1/4" QC	
EB12LB-6	2301	5	3.7	17.8	0.7	358.8	14.1	0.69	1.52	1/4" QC	
EB02LB-6	782	6	4.4	17.8	0.7	358.8	14.1	0.74	1.63	1/4" QC	
EB12LB-9	1595	9	6.6	17.8	0.7	358.8	14.1	0.69	1.52	1/4" QC	
EB02LB-9	505	9	6.6	17.8	0.7	358.8	14.1	0.74	1.63	1/4" QC	
EB12LB-14	1022	14	10.3	17.8	0.7	358.8	14.1	0.69	1.52	1/4" QC	
EB12LB-20	659	20	14.8	17.8	0.7	358.8	14.1	0.69	1.52	3/8" SD	

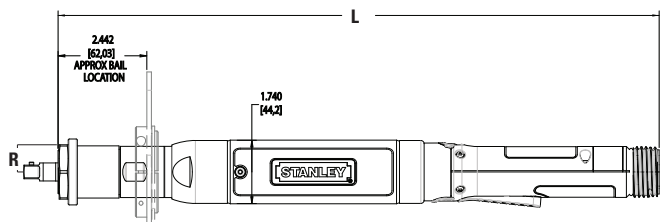

Model	Rated Speed		Torque		"R" Side to Center		"L" Length		Weight		Output
	RPM	Nm	lb ft	mm	in	mm	in	kg	lb	Standard	
EB22LB-16	1339	16	11.8	23.7	0.93	351.6	13.8	1.06	2.33	3/8" SD	
EB22LB-28	731	27	19.9	23.7	0.93	351.6	13.8	1.06	2.33	3/8" SD	
EB33LB-28	1590	28	20.7	24.7	0.97	415.9	16.4	1.40	3.08	3/8" SD	
EB33LB-40	1117	39	28.8	24.7	0.97	415.9	16.4	1.40	3.08	3/8" SD	

EB Inline Tool Options

EB02LP, EB12LP

Output Options	Part No.
1/4" SD	20D119302
3/8" SD Socket Lock Pin	Part No.
Standard	20D227800
Rounded (Ball Detent)	20D227801
Reaction Bar	Part No.
Reaction Bar, Aluminum 17"	20K100103
Reaction Bar, Aluminum 12"	20K101601
PTS Spline Cover	20D217001

EB Inline Tool Options

EB02, EB12

Output Options	Part No.
3/8" SD	20D119301
1/4" SD	20D119302
3/8" SD Socket Lock Pin	Part No.
Standard	20D227800
Rounded (Ball Detent)	20D227801
Reaction Bar	Part No.
Reaction Bar, Aluminum	F3698
Reaction Bar, Steel	20K100100
Base Mount Bracket	A8606
Mounting Flange-B	20K101000

EB Inline Tool Options

EB22, EB33

Output Options	Part No.
3/8" 24-Thread	20D281100
Reaction Bar	Part No.
Reaction Bar, Aluminum	F3698
Reaction Bar, Steel	20K100100
Base Mount Bracket	A8606
Mounting Flange-B	20K101000
3/8" SD Socket Lock Pin	Part No.
Standard	20D227800
Rounded (Ball Detent)	20D227801
Suspension Bails	Part No.
Wire Bail	A3061
Swivel	20K101400
Standard	B3432

Inline Tools (55 to 2000 Nm)

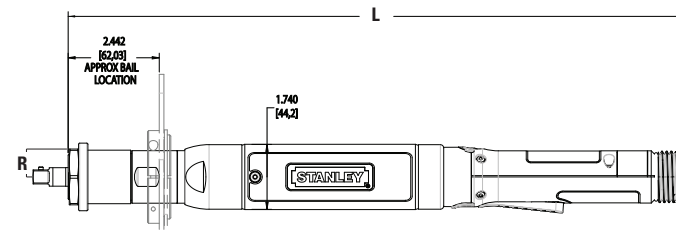

Model	Rated Speed		Torque		"R" Side to Center		"L" Length		Weight		Output
	RPM	Nm	lb ft	mm	in	mm	in	kg	lb	Standard	
EB34LB1-55	830	55	40.6	24.7	0.97	463.4	18.2	2.04	4.49	1/2" SD	
EB34LB1-75	546	75	55.3	24.7	0.97	485.3	19.1	2.04	4.49	1/2" SD	
EB44LB1-80	895	79	58.3	24.7	0.97	478.9	18.9	2.48	5.46	1/2" SD	
EB34LB1-105	407	105	77.4	24.7	0.97	485.3	19.1	2.04	4.49	1/2" SD	
EB44LB1-120	557	119	87.8	24.7	0.97	478.9	18.9	2.48	5.46	1/2" SD	
EB45LB2-140	463	140	103.3	34	1.35	533	21	3.42	7.52	3/4" SD	
EB55LB2-170	639	170	125.4	34	1.35	560	22.1	4.06	8.93	3/4" SD	
EB45LB2-190	355	190	140.1	34	1.35	533	21	3.42	7.52	3/4" SD	
EB55LB2-250	401	250	184.4	34	1.35	560	22.1	4.06	8.93	3/4" SD	
EB45LB2-250	268	250	184.4	34	1.35	533	21	3.42	7.52	3/4" SD	
EB55LB3-320	312	320	236	32	1.25	573	22.5	6.49	14.28	3/4" SD	
EB55LB4-460	222	460	339.3	44	1.7	621	24.4	3.06	6.73	1" SD	
EB55LB4-620	165	620	457.2	44	1.7	621	24.4	3.06	6.73	1" SD	
EB55LB4-800	123	800	590.1	44	1.7	621	24.4	3.06	6.73	1" SD	
EB55LB5-1100	81	1099	810.6	48	1.9	651	25.6	10.57	23.25	1" SD	
EB55LB5-1500	60	1500	1106.4	48	1.9	683	26.9	10.57	23.25	1" SD	
EB55LB5-2000	48	2000	1475.2	48	1.9	683	26.9	10.57	23.25	1" SD	

EB Inline Tool Options

EB34, EB44, EB45, EB55

Reaction Bar	Part No.
Reaction Bar Assembly	20K100000
Mounting Flange Assembly	20K100300
Base Mount Bracket Assembly	20K100500
Suspension Bails	Part No.
Wire Bail	A3061
Swivel	20K200000
1/2" SD Socket Lock Pin	Part No.
Standard	20D227800
Rounded (Ball Detent)	20D227801